

CURVE CONTROL

MAGNETIC ATTACHMENT
FOR CURVE STAMPING



INSTRUCTIONS & TIPS

MADE BY TAIUS TOOLS

the tool.

The **CURVE CONTROL** attachments are designed to support precise stamping along the edge of round metal blanks.

They ensure consistent spacing and controlled alignment, making them suitable for names, phone numbers, and decorative patterns on round metal blanks with a diameter of up to 32 mm (1 ¼ inches).

The attachments support repeatable and evenly spaced curved impressions when used in combination with the Perfect Print Tool.

Ben

Questions or Feedback?

Feel free to reach out via email or Instagram.

We are happy to help!



info@taius-tools.de



[@taius.tools](https://www.instagram.com/taius.tools)

HOW TO:

one.

Place the magnetic Curve Control on a 10 × 10 cm (4 × 4 inch) steel block.

Insert the Perfect Print Tool into the Curve Control.

Position a round metal blank (max. Ø 32 mm / 1¼ inches) into the curved guide of the Curve Control.



two.

Attach the metal stamp as to the Perfect Print tool.

Move the Perfect Print Tool up or down until the desired stamping position is reached.

To ensure a centered impression, select the 6.3 mm or 9 mm Curve Control attachment according to the width of the metal stamp.

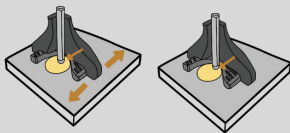

three.

Identify the hole in the Curve Control that is closest to the Perfect Print Tool.

Insert the metal pin into this hole to lock the position.

A detailed explanation of the hole positions can be found in the Tips section.

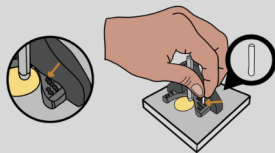

four.

Gently press the metal blank against the Curve Control using the ring finger.

Using the other hand, slide the metal stamp downward until it makes contact with the metal blank.

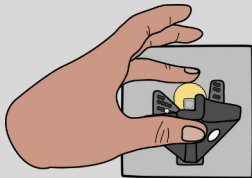

five.

Apply light upward pressure with the thumb from underneath the Perfect Print Tool, ensuring it is fully seated against the metal pin.

Hold the metal stamp with the index and middle finger and strike firmly with a single hammer blow.

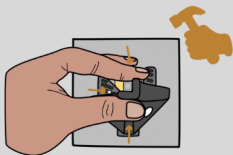

six.

Rotate the metal blank slightly clockwise.

Repeat the previous positioning and stamping steps until the desired name, phone number, or pattern has been stamped evenly along the curve.

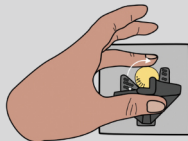

Share your creative projects and tag us on Instagram!

We can't wait to see your stamping projects!



info@taius-tools.de



[@taius.tools](https://www.instagram.com/taius.tools)

TIPS:

6.3 mm tool.

The 6.3 mm tool is intended for use with metal stamps that have an exact face width of 6.3 mm (1/4 inch).

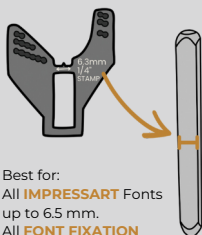

Best for:
All **IMPRESSART** Fonts
up to 6.5 mm.
All **FONT FIXATION**
Fonts up to 4 mm.

9 mm tool.

The 9 mm tool is intended for use with metal stamps that have an exact face width of 9 mm (1/3 inch).

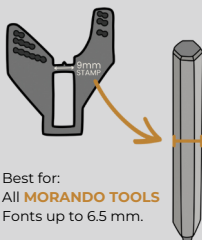

Best for:
All **MORANDO TOOLS**
Fonts up to 6.5 mm.

Need a different size?

Feel free to reach out and we will design a custom Curve Control Tool just for you!

info@taius-tools.de



hole settings.

The green-marked holes are spaced at **0.5 mm intervals**, while the red-marked holes are spaced at **1 mm intervals**.

This allows the Perfect Print Tool to be adjusted in 0.5 mm or 1 mm increments and secured in position using the metal pin.

Depending on the diameter of the metal blank, the distance between the stamp impression and the edge will vary.

Test different settings to determine the most suitable position for the specific blank.

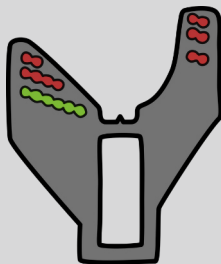

The position of the Curve Control Tool determines the distance between the stamp impression and the edge of the metal blank, supporting consistent spacing.

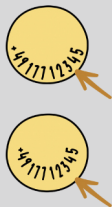

Questions or Feedback?

Feel free to reach out via email or Instagram.
We are happy to help!



info@taius-tools.de



[@taius.tools](https://www.instagram.com/taius.tools)